

Road Case

02/05/15

PNE

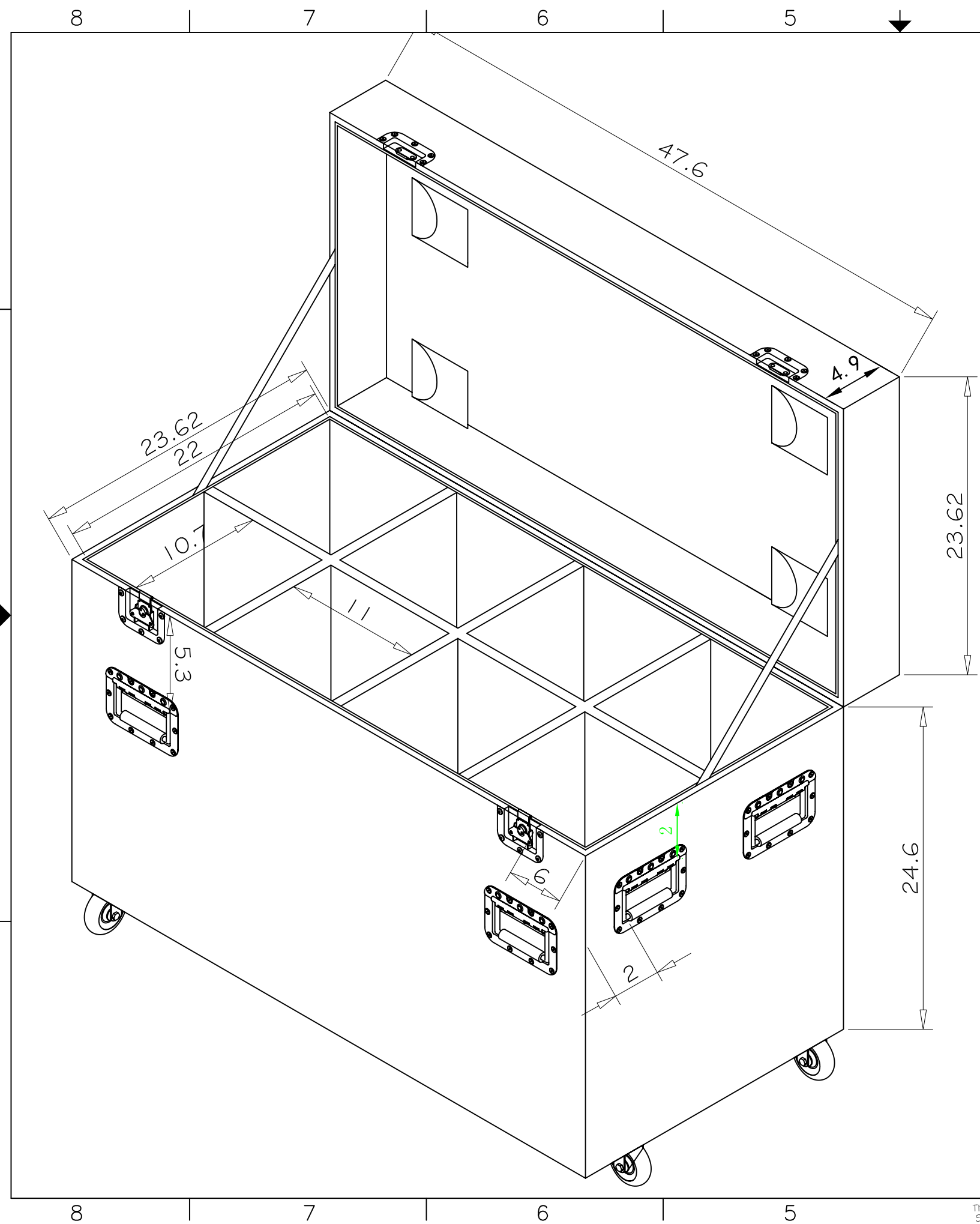

REV		DESCRIPTION	DATE	APPROVED

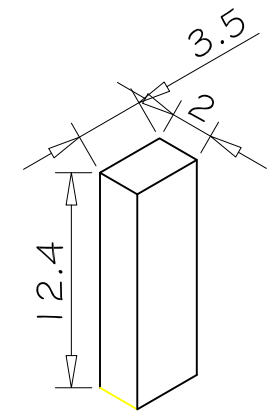
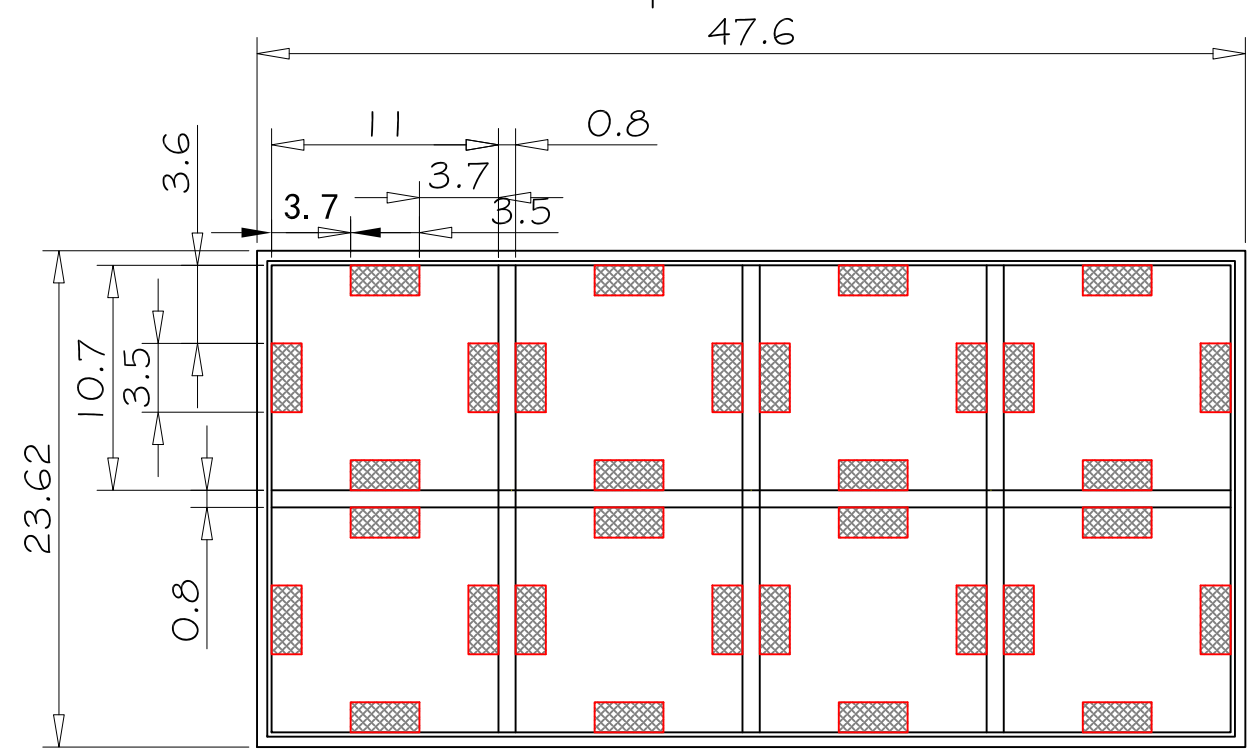

C S4 Ieko Case

- Note:
1. Foam 5mm EVA
 2. Dist' btw rivets 120 mm
 3. 12mm thick plywood
 4. Panel : ABS board
 5. Wheels 4-inch round four with no brakes

315mm foam EVA3



c S4 par
Road Case

SIZE B	FSCM NO.	DWG NO.
SCALE 3	NONE	SHEET 1 1 REV